

# EV21LE

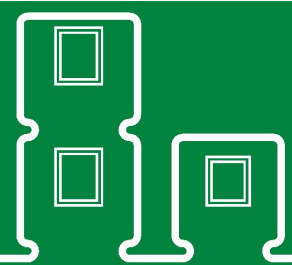

**EV21LE** is a functional EVAC module with one living/bedroom, kitchen with dining area, WC with a shower and an entrance/wardrobe room. Can be connected to other our EVAC and site hut modules, especially with the module EV22L and EV23L

## PRODUCT SPECIFICATION:

Building area	24,3 m <sup>2</sup>
Total area, of which	21,5 m <sup>2</sup>
- Entrance/Wardrobe	6,0 m <sup>2</sup>
- WC/Shower	2,5 m <sup>2</sup>
- Kitchen/Dining	6,0 m <sup>2</sup>
- Bedroom	7,0 m <sup>2</sup>
Transportation measures	2950 x 8570 x 3000 mm
Inside Measures	2582 x 8092 x 2400 mm
Weight	ca' 5400 kg
Roof angle	1:60

## INCLUDING:

- C01 - Galvanized steel profile frame, liftable with forklift and crane
- F36 - Clothes hanger hook 1 pc on wall
- F37 - Clothes hanger hooks 4 pc on wall
- F58 - Cabinet under basin
- F69 - Kitchen cabinet set
- F73 - Fridge L
- F80 - Stove with oven
- F82 - Microwave oven
- F83 - Cooker hood, filtering
- F90 - Mirror on wall
- P53 - Ceramic basin L with mixer
- P55 - Sink, stainless, with mixer
- P68 - Shower area set, incl.; floor drainage, curtain, shower mixer
- P70 - Toilet seat and toilet paper roll holder
- H20 - Electrical towel dryer
- H40 - Water heater 100 L

## AVAILABLE AS ADD ON PRODUCTS:

- S05 - Window grid 900x1200 mm
- S18 - Venetian blind 900x1200 mm
- S25 - SmartLock for doors
- F25 - Bed Single 900x2000 mm with mattress
- F51 - Cabinet with shelves
- F60 - Wardrobe
- H50 - Heat Pump/Air Conditioning (Air-Air)
- V35 - Wall fan OUT-100/IN-100 with heat recovery
- E10 - Electrical connection cable 32A when campus building
- External connections when campus building
- Internal connections when campus building
- Fire resistant structures

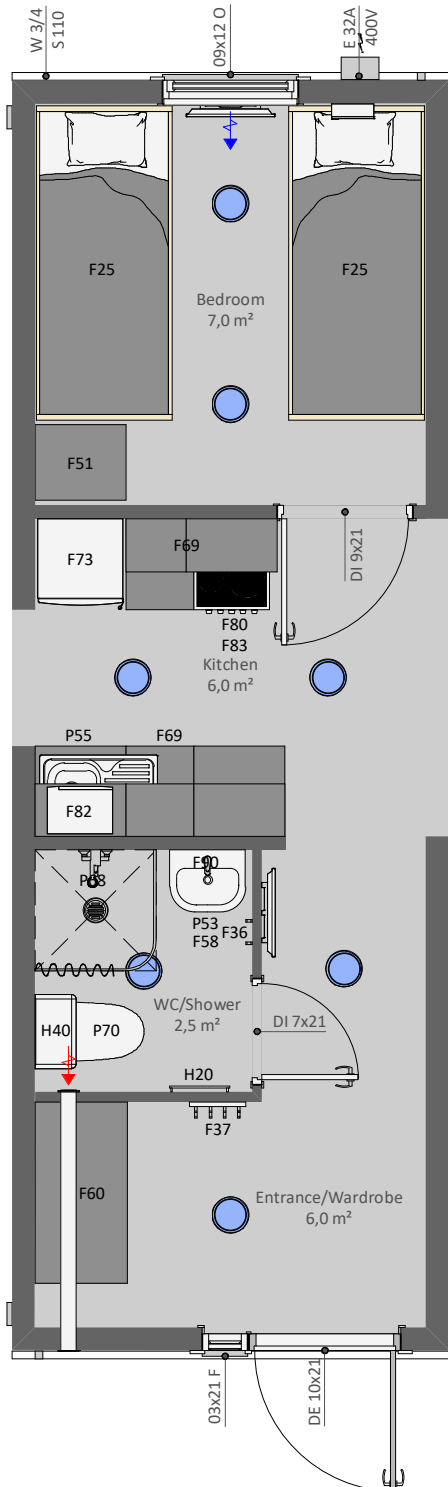

Producer:



GREENTEC HOUSES OÜ  
<https://greentec.ee>