

T21

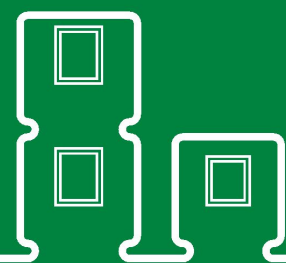

T21 is an upper floor staircase module with one office room

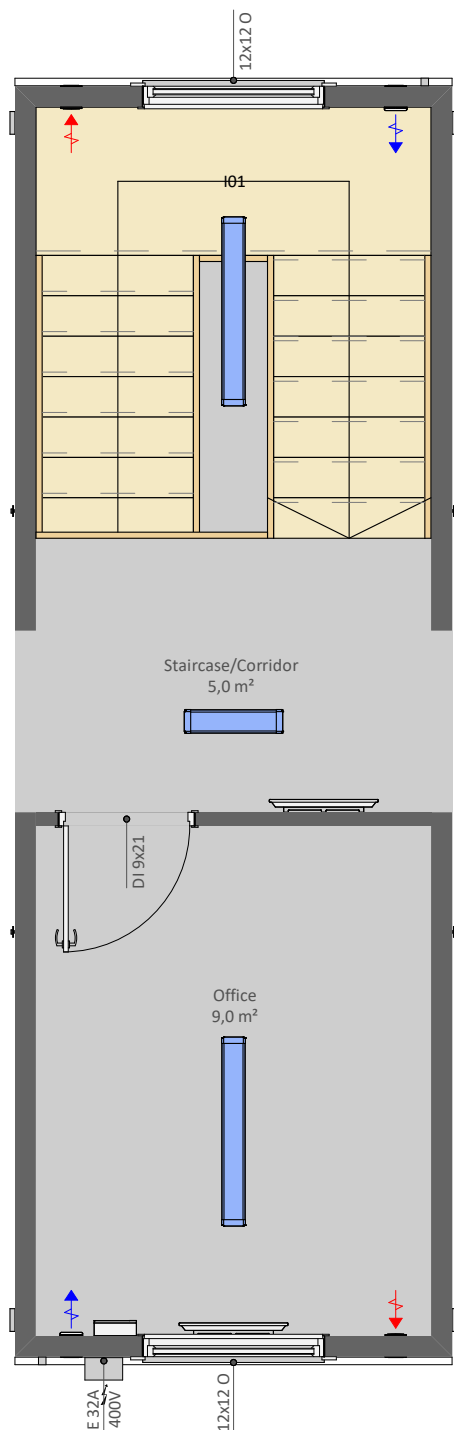

PRODUCT SPECIFICATION:

Building area	24,3 m ²
Total area, of which	14,0 m ²
- Staircase/Corridor	5,0 m ²
- Office	9,0 m ²
Transportation measures	2950 x 8570 x 3000 mm
Inside Measures	2620 x 8120 x 2400 mm
Weight	ca´ 4700 kg
Roof angle	1:60

INCLUDING:

C01 - Galvanized steel profile frame, liftable with forklift and crane
 I01 - Wooden varnished staircase with fences

AVAILABLE AS ADD ON PRODUCTS:

CEWB - Long side wall opening element B (filling element)
 CEWC1 - Long side wall opening element C1 (without door leaf)
 CEWC2 - Long side wall opening element C2 (with ext. door leaf)
 CEWC3 - Long side wall opening element C3 (with int. door leaf)
 CEWC4 - Long side wall opening element C4 (with remov. fill. elem.)
 S05 - Window grid 1200x1200 mm
 S18 - Venetian blind 1200x1200 mm
 S22 - Locking bar for external door
 S25 - SmartLock for doors
 H50 - Heat Pump/Air Conditioning (Air-Air)
 V35 - Wall fan OUT-100/IN-100 with heat recovery
 E10 - Electrical connection cable 32A when campus building

- External connections when campus building
- Internal connections when campus building

Producer: