

T20

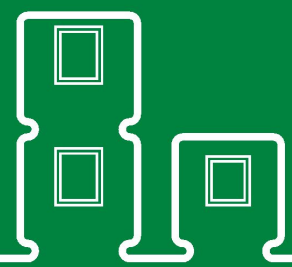

T20 is a single open space upper floor staircase module

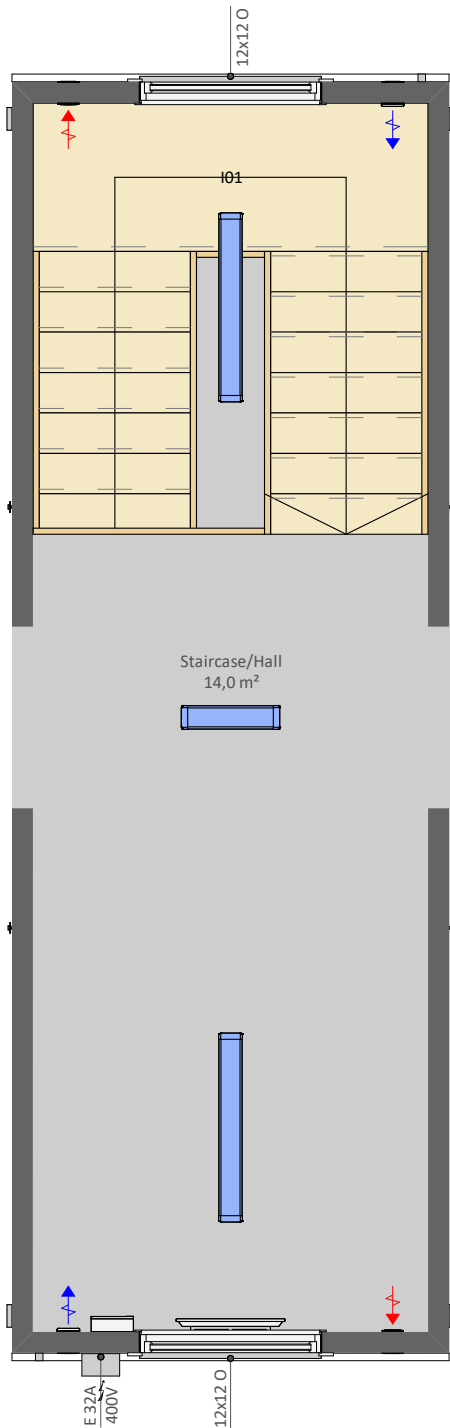

PRODUCT SPECIFICATION:

Building area	24,3 m ²
Total area, of which	14,0 m ²
- Staircase/Hall	14,0 m ²
Transportation measures	2950 x 8570 x 3000 mm
Inside Measures	2620 x 8120 x 2400 mm
Weight	ca' 4600 kg
Roof angle	1:60

INCLUDING:

C01 - Galvanized steel profile frame, liftable with forklift and crane
I01 - Wooden varnished staircase with fences

AVAILABLE AS ADD ON PRODUCTS:

- CEWB - Long side wall opening element B (filling element)
- CEWC1 - Long side wall opening element C1 (without door leaf)
- CEWC2 - Long side wall opening element C2 (with ext. door leaf)
- CEWC3 - Long side wall opening element C3 (with int. door leaf)
- CEWC4 - Long side wall opening element C4 (with remov. fill. elem.)
- S05 - Window grid 1200x1200 mm
- S18 - Venetian blind 1200x1200 mm
- S22 - Locking bar for external door
- S25 - SmartLock for doors
- H50 - Heat Pump/Air Conditioning (Air-Air)
- V35 - Wall fan OUT-100/IN-100 with heat recovery
- E10 - Electrical connection cable 32A when campus building
 - External connections when campus building
 - Internal connections when campus building

Producer: