

# T21G

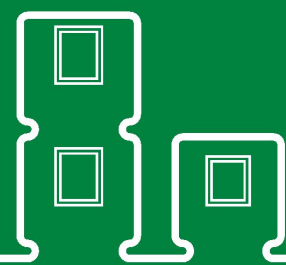

**T21G** is an upper floor staircase module with one office room

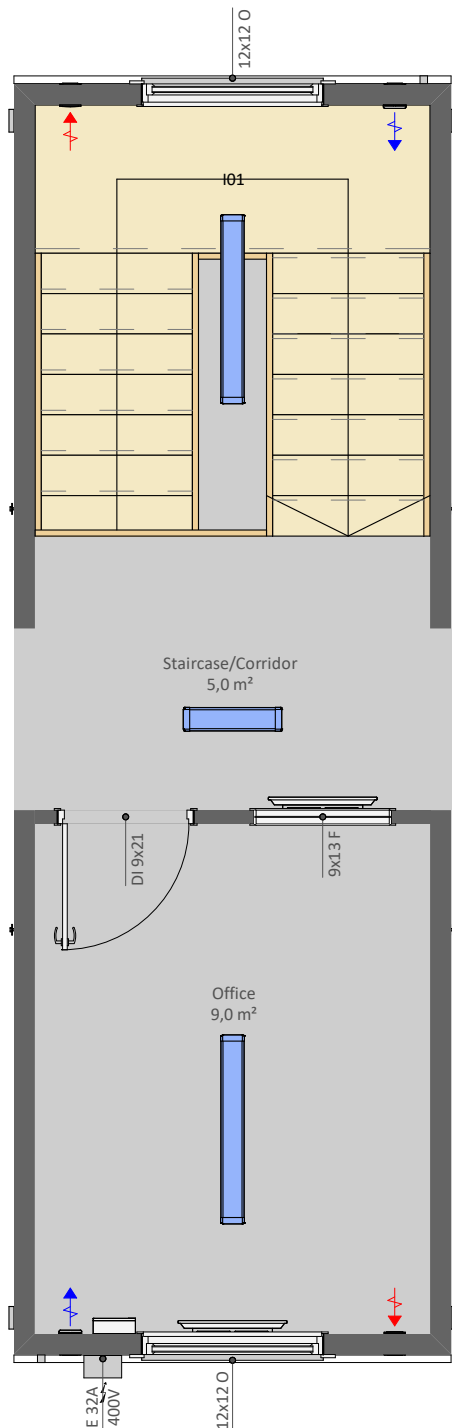

## **PRODUCT SPECIFICATION:**

Building area	24,3 m <sup>2</sup>
Total area, of which	14,0 m <sup>2</sup>
- Staircase/Corridor	5,0 m <sup>2</sup>
- Office	9,0 m <sup>2</sup>
Transportation measures	2950 x 8570 x 3000 mm
Inside Measures	2620 x 8120 x 2400 mm
Weight	ca' 4700 kg
Roof angle	1:60

## **INCLUDING:**

C01 - Galvanized steel profile frame, liftable with forklift and crane  
I01 - Wooden varnished staircase with fences

## **AVAILABLE AS ADD ON PRODUCTS:**

CEWB - Long side wall opening element B (filling element)  
CEWC1 - Long side wall opening element C1 (without door leaf)  
CEWC2 - Long side wall opening element C2 (with ext. door leaf)  
CEWC3 - Long side wall opening element C3 (with int. door leaf)  
CEWC4 - Long side wall opening element C4 (with remov. fill. elem.)  
S05 - Window grid 1200x1200 mm  
S18 - Venetian blind 1200x1200 mm  
S22 - Locking bar for external door  
S25 - SmartLock for doors  
H50 - Heat Pump/Air Conditioning (Air-Air)  
V35 - Wall fan OUT-100/IN-100 with heat recovery  
E10 - Electrical connection cable 32A when campus building

- External connections when campus building
- Internal connections when campus building

Producer: